

+ LUX ELEMENTS®-TUB-LINE ...

Montageanleitung · Instructions for assembly · Instruction de montage · Montagehandleiding

Technische Änderungen vorbehalten · We reserve the right to make technical changes · Sous réserve de modifications techniques · Onder voorbehoud van technische veranderingen
11 | 2017

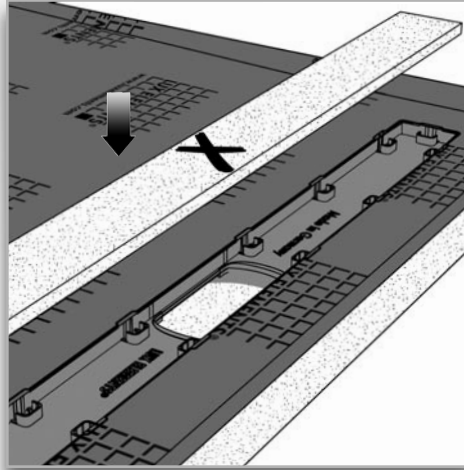

(DE) – BITTE BEACHTEN ... vor Montagebeginn beiliegenden Bautenschutz ('X') einsetzen!

(EN) – PLEASE OBSERVE ... insert protective cover ('X') before installation!

(FR) – VEUILLEZ TENIR COMPTE ... veillez à intégrer la protection ('X') avant montage !

(NL) – LET OP ... voor montagebegin de bijbehorende gootbescherming ('X') invoegen!

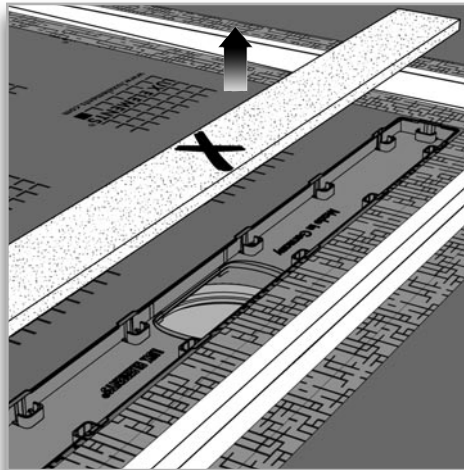

(DE) – BITTE BEACHTEN ... vor der Verfliesung den Bautenschutz ('X') entfernen!

(EN) – PLEASE OBSERVE ... remove protective cover ('X') before tiling!

(FR) – VEUILLEZ TENIR COMPTE ... retirer la protection (X) avant de carreler !

(NL) – LET OP ... voor het betegelen de gootbescherming ('X') verwijderen!

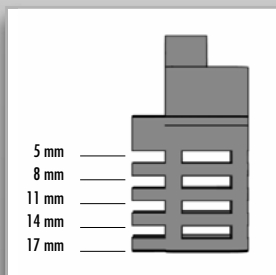

(DE) – Anflieshilfe und Abdecksteg vor der Verfliesung und Verfugung montieren.

(EN) – Install tiling aid and cover rail before tiling and jointing.

(FR) – Positionner le cadre d'aide à la pose du carrelage et le grille en ligne avant de carreler et jointer.

(NL) – Tegelhulp en afdekbrug monteren alvorens te betegelen en te voegen.

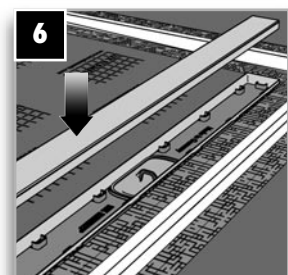
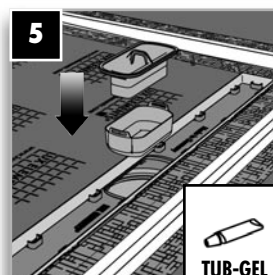
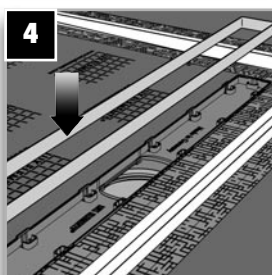
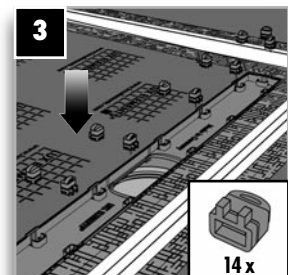
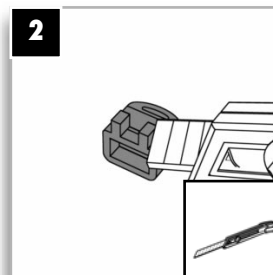
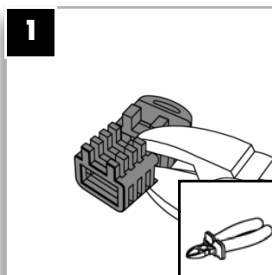

TUB-GEL

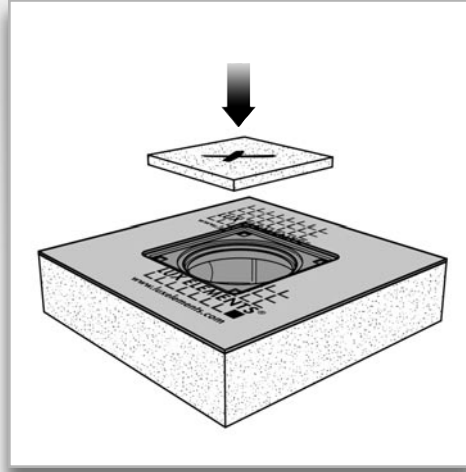

(DE) – BITTE BEACHTEN ... vor Montagebeginn beiliegenden Bautenschutz ('X') einsetzen!

(EN) – PLEASE OBSERVE ... insert protective cover ('X') before installation!

(FR) – VEUILLEZ TENIR COMPTE ... veillez à intégrer la protection ('X') avant montage !

(NL) – LET OP ... voor montagebegin de bijbehorende bescherming ('X') invoegen!

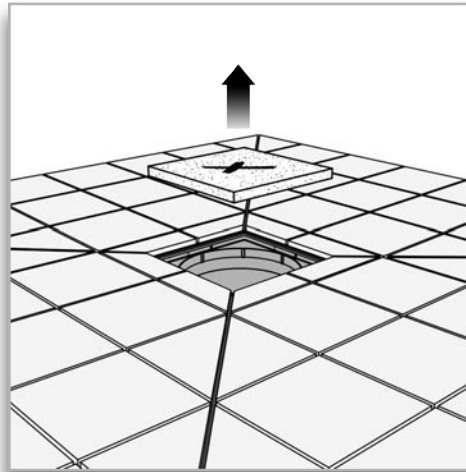

(DE) – BITTE BEACHTEN ... vor dem Einpassen der Rostaufnahme den Bautenschutz ('X') entfernen!

(EN) – PLEASE OBSERVE ... remove protective cover ('X') before fitting the grate!

(FR) – VEUILLEZ TENIR COMPTE ... retirer le couvercle de protection (X) avant intégration du support !

(NL) – LET OP ... Voor het inpassen van het rooster de bescherming ('X') verwijderen!

