

2.1 ▶ 2.6
=

1.1 ▶ 1.6

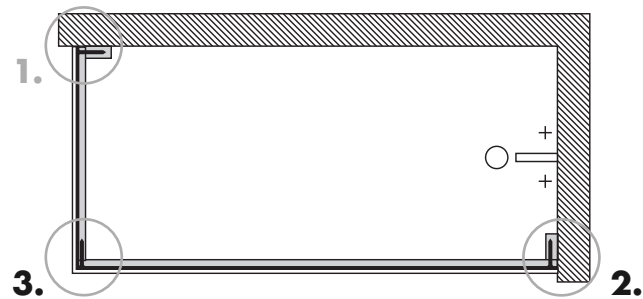

LUX ELEMENTS®
www.luxelements.com

LUX ELEMENTS®

Wannenverkleidungen · Bath tub surrounds · Habillages pour baignoires · Badkuipbekledingen

LUX ELEMENTS®-TOP-TR...

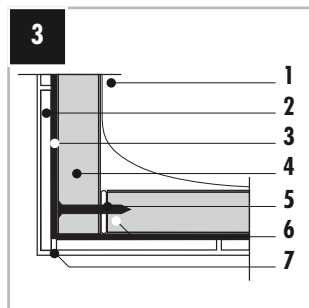

- 1 - Wanne · Bathtub · Baignoire · Badkuip
2 - Fliesenbelag · Tile covering
Revêtement carrelé · Tegelsbekleding
3 - Fliesenkleber · Tile adhesive
Colle à carrelage · Tegellijm
4 - TOP-TR...
5 - COL-MK
6 - FIX-SD 80
7 - Versiegelung · Sealing
Scellement · Verzegeling

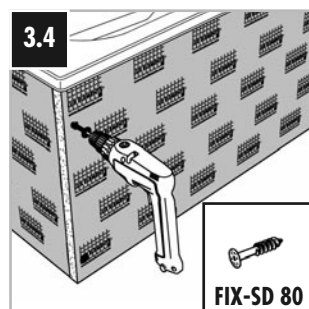
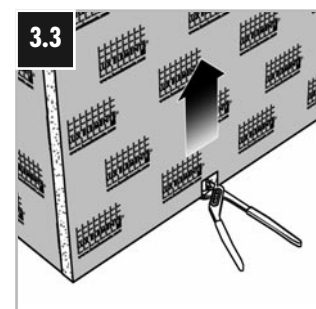
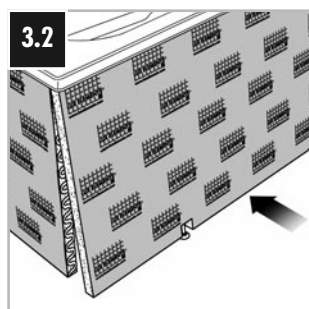
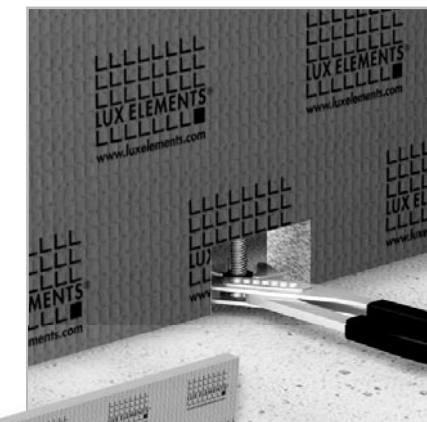
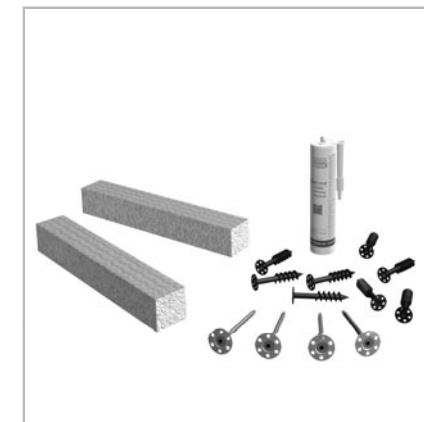
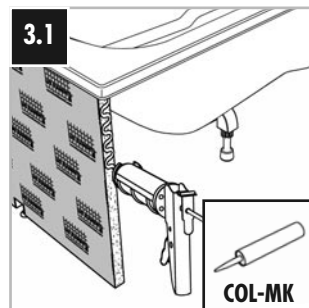

D
LUX ELEMENTS GmbH & Co. KG
An der Schusterinsel 7
D - 51379 Leverkusen-Opladen

Tel. +49 (0) 21 71/ 72 12 - 0
Fax +49 (0) 21 71/ 72 12 40

info@luxelements.de
www.luxelements.com

F
LUX ELEMENTS S.A.S
ZI-31, rue d'Ensisheim
F - 68190 Ungersheim

Tél. +33 (0) 3 89 83 69 79
Fax +33 (0) 3 89 48 83 27

info@luxelements.fr
www.luxelements.fr

■ + ABLAGE · + SHELF · + TABLETTE · + PLANCHET

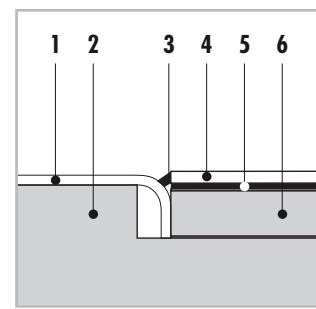
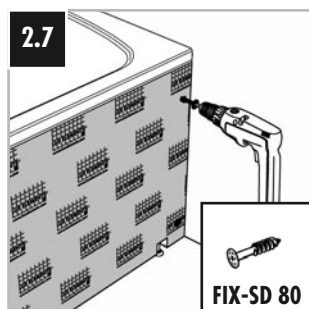

- 1 - Wanne · Bathtub · Baignoire · Badkuip
2 - TOP-TR...
3 - Versiegelung · Sealing
Scellement · Verzegeling
4 - Fliesenbelag · Tile covering
Revêtement carrelé · Tegelsbekleding
5 - Fliesenkleber · Tile adhesive
Colle à carrelage · Tegellijm
6 - Ablage · Shelf · Tablette · Planchet
LUX ELEMENTS®-ELEMENT-EL 30/50

PROS3160 · 09/2018 [DE] – Technische Änderungen vorbehalten
Unsere Artikel variieren bezüglich des Lieferumfangs. Beachten Sie hierzu die Angaben z.B. in der Produktbeschreibung, der Auftragsbestätigung oder auf der Verpackung.

09/2018 [EN] – We reserve the right to make technical changes
Our products vary regarding the scope of delivery. Please refer to the information, for example, in the product description, the order confirmation or on the packaging.

09/2018 [FR] – Sous réserve de modifications techniques
Fiche de montage générale, selon le choix du produit, celui-ci peut-être livré avec des options. Veuillez vous référer aux informations, description de produit, confirmation de commande ou à l'emballage pour connaître le contenu.

09/2018 [NL] – Onder voorbehoud van technische veranderingen
Onze producten variëren in de omvang van de levering. Raadpleeg de informatie, bijvoorbeeld, in de productbeschrijving, de orderbevestiging of op de verpakking.

www.luxelements.com

[DE] – Montageanleitung

[EN] – Instructions for assembly

[FR] – Instructions de montage

[NL] – Montagehandleiding

■ LUX ELEMENTS®-TOP

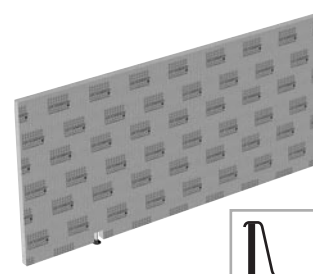

...-TRS

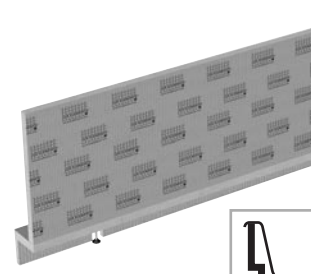

...-TRU

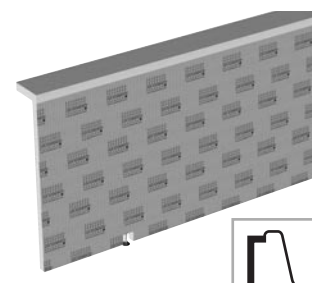

...-TRV

■ LUX ELEMENTS®-TOP-KIT



2x TOP-AN



4x FIX-FID 110



8x FIX-SD 80



1x COL-MK, 290 ml

■ EINBAUSITUATIONEN · INSTALLATION SITUATIONS · SITUATIONS DE MONTAGE · INBOUWSITUATIES



■ WERKZEUGE · TOOLS · OUTILS · GEREEDSCHAPPEN

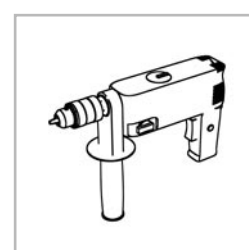
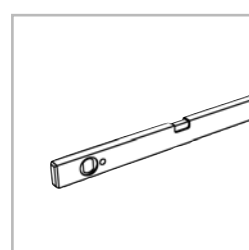

Ø 8 mm

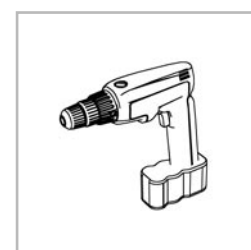
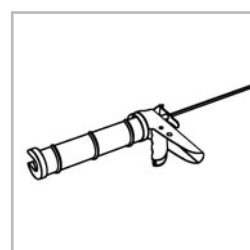
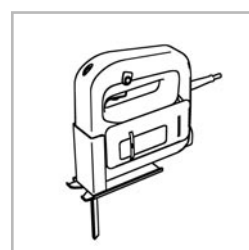
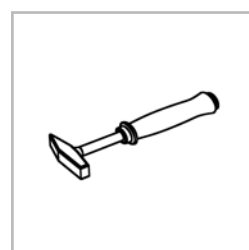

[DE] – Die Badewanne ist positioniert, mit Hilfe der Wannenfüße ausgerichtet und die Anschlüsse sind fachgerecht montiert.

[EN] – The bathtub is positioned and aligned by means of the tub legs, and the connections are professionally mounted.

[FR] – La baignoire est déjà positionnée, ajustée à l'aide de pieds réglables et les raccords sont montés de façon conforme.

[NL] – De badkuip is gepositioneerd, met behulp van de poten uitgelijnd en de aansluitingen zijn vakkundig gemonteerd.



Montagevideo · Installation video · Installatievideo:

www.youtube.com/user/luxelementscom

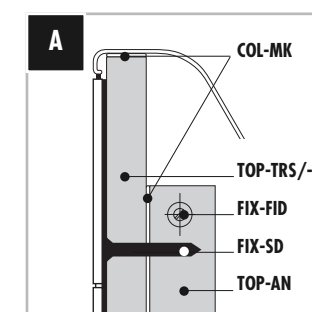

...-TRS/-TRU

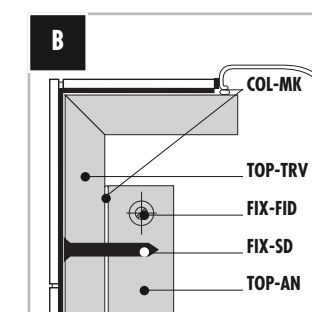

...-TRV

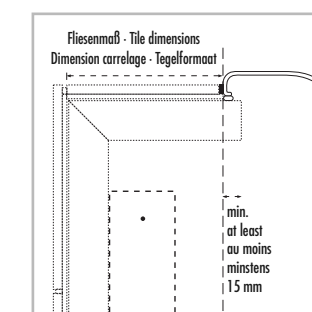

min.
 at least
 ou moins
 minstens
 15 mm

■ z.B. ECKEINBAU · e.g. CORNER INSTALLATION · par ex. MONTAGE EN ANGLE · b.v. INBOUW IN HOEK

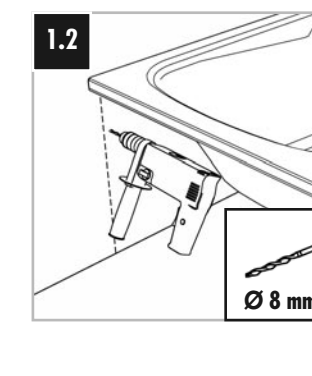
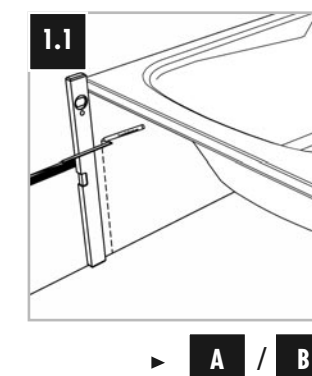
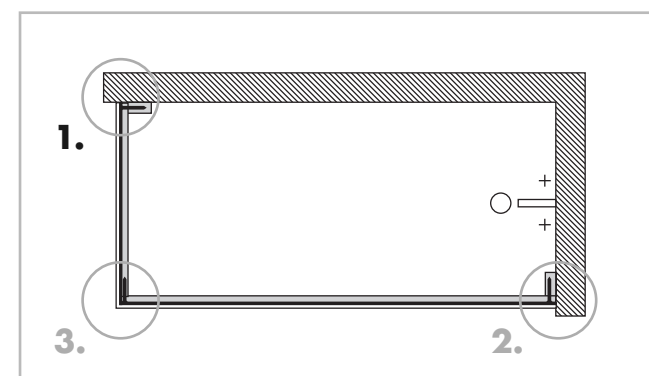

Ø 8 mm

► A / B

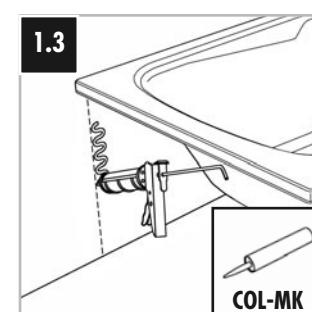

COL-MK

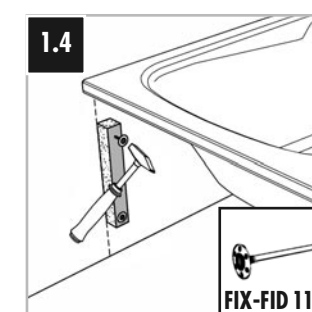

FIX-FID 110

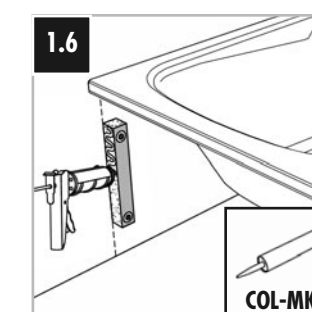
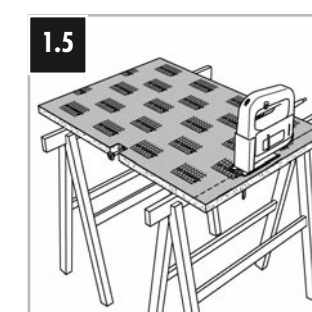

COL-MK

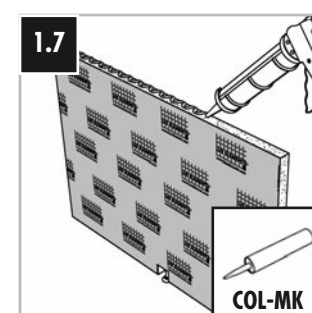

COL-MK

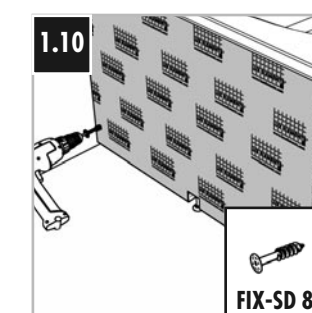
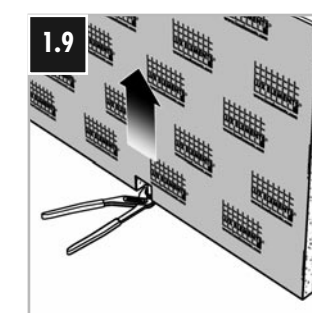
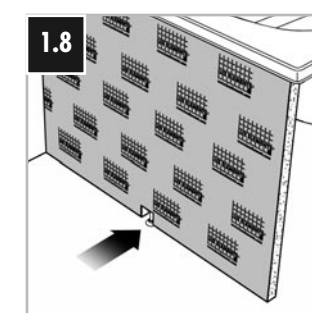

FIX-SD 80